

IMPELLER

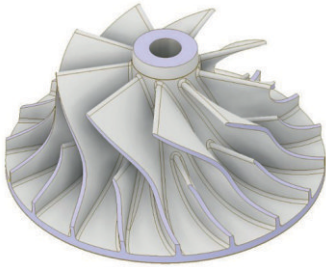

CAD model

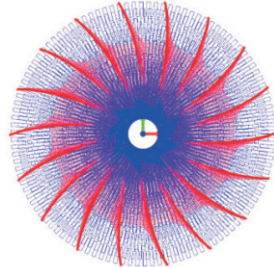

CAD model - top view

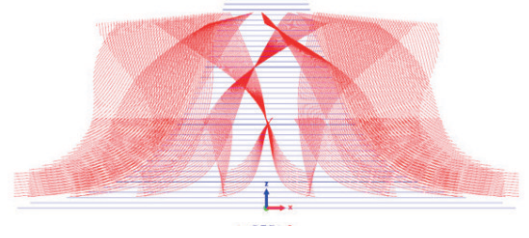

CAD model - side view



Metal printed part



Partly machined part

INFORMATION ON THE COMPONENT PART

- Application: Turbocharger for marine diesel engines.
- Conventional manufacturing technology: Milling.
- Problem with conventional procurement:
 - » Very high chip volume → high costs of milling.
 - » High storage costs of geometry-dependent wrought material.
 - » Long delivery times of wrought material.
 - » High utilization of turning/milling centers.

TECHNICAL DATA

Machine: arc405

Dimension [In/mm]:

D = 11.42in / 290mm

H = 4.72in / 120mm

Wire:

1.4370 | Ø 0.04in / 1.0 mm

Printing mass:



42.77lb / 19,4 kg

Printing time: 7.00 h

ALTERNATIVE TO THE MILLING PROCESS 3DMP®

- Fast, flexible and just-in-time procurement of the near-net-shape blanks as required.
- Shortening of the required turning/milling time.
- Reduction of the chip volume.

BENEFITS OF 3DMP®

-  Reduction of manufacturing time
-  Cost savings
-  Small units
-  Material savings

Fastech LLC

232 Slayton Ave
Danville VA 24540

Askus@fastech-engineering.com
Tel: +1 (434) 766 6632

www.Fastech-Engineering.com



FASTTECH LLC

Fastech LLC is ISO 9001:2015 certified